

# -17C Executive, Three Position Knee Tilt Control

Shown below with optional seat slider.

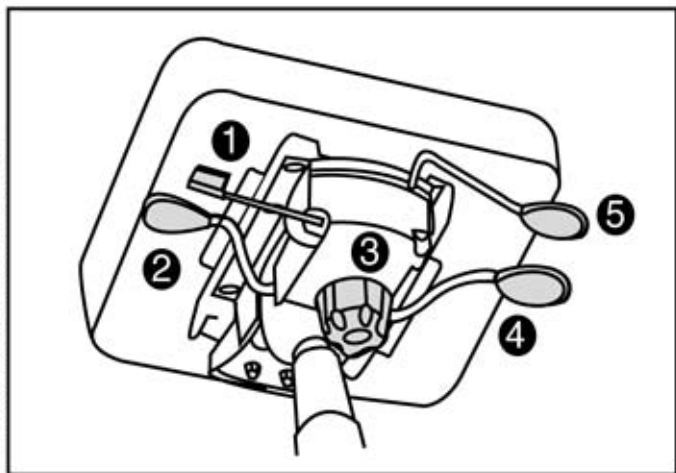

VIA Customer Service: 800-433-6614

**1 Three Position Forward Tilt** - (Located just under the front, right corner of the seat cushion). To activate lean back slightly, and rotate lever to the desired angle position. The seat and back will return to the selected seat angle when you lean forward.

**2 Pneumatic Height Adjustment** - (Located on the right side, just below the seat cushion). To raise the chair, lift your weight from the chair and lift the lever. To lower the chair, while seated, lift the lever upward, lower to desired height. Release lever to lock the chair at the desired height.

**3 Body Weight Adjustment Knob** - (Located below the front center of the seat cushion). While seated, rotate the adjustment knob to the left to increase tilt tension. Rotate adjustment knob to the right to decrease tilt tension.

**4 Tilt Lock Adjustment** - (Located on the left side, just below the seat cushion). To lock the chair in an upright position, shift your weight forward until the chair is in an upright position, then push lever down. To rock (free float) shift your weight forward and lift forward.

**5 Seat Slider** - Shown above, is optional. Pull lever up to adjust seat slide forward or back. Push down to lock seat slider in position.