

Single Position Knee Tilt Control

Shown with optional
seat slider.

Weight Capacity 275 lbs.

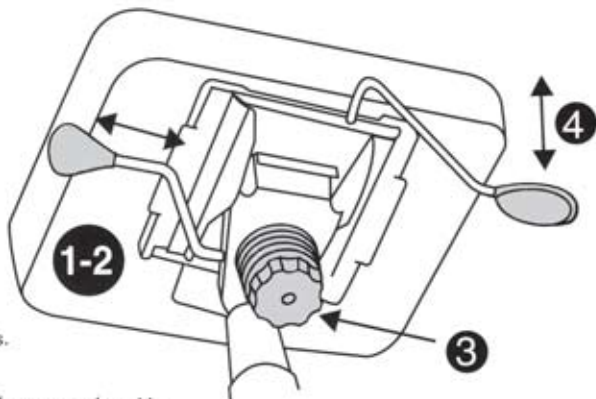

Adjustments described from seated position.

- 1 Pneumatic Height Adjustment** - Located on the right side, just below the seat cushion. To raise the chair, lift your weight from the chair and lift the lever. To lower the chair, while seated, lift the lever upward, lower to desired height. Release lever to lock the chair at the desired height.
- 2 Tilt Lock - Same Lever as Height Adjustment** - Located on the right side, just below the seat cushion. To lock the chair in an upright position, shift your weight forward until the chair is in an upright position. Then push lever in. To rock (free float) shift your weight forward and pull the lever out.
- 3 Tilt Tension Adjustment Knob** - Located below the front, center of the seat cushion. While seated, rotate the adjustment knob to the left to increase tilt tension. Rotate to the right to decrease tilt tension.
- 4 Seat Slide** - Shown above (is optional). Pull lever up to adjust seat slide forward or back. Push down to lock seat slide in position.